



Table: FAR, GROUND COVERAGE & UNIT DETAIL. Columns: S.NO., DESCRIPTION, G. COVERAGE, FAR, HEIGHT, NO. OF DWELLING UNIT, MAIN UNITS.

Table: PARKING CALCULATION. Columns: PARKING REQUIRED FOR RESIDENTIAL, COMMERCIAL, COMMUNITY FACILITY, VIEWING GALLERY, TOTAL PARKING REQUIRED, PARKING PROVIDED AS NOS.

Table: Phasing Details. Columns: Phase, Tower, Total No. of Dwelling Units.

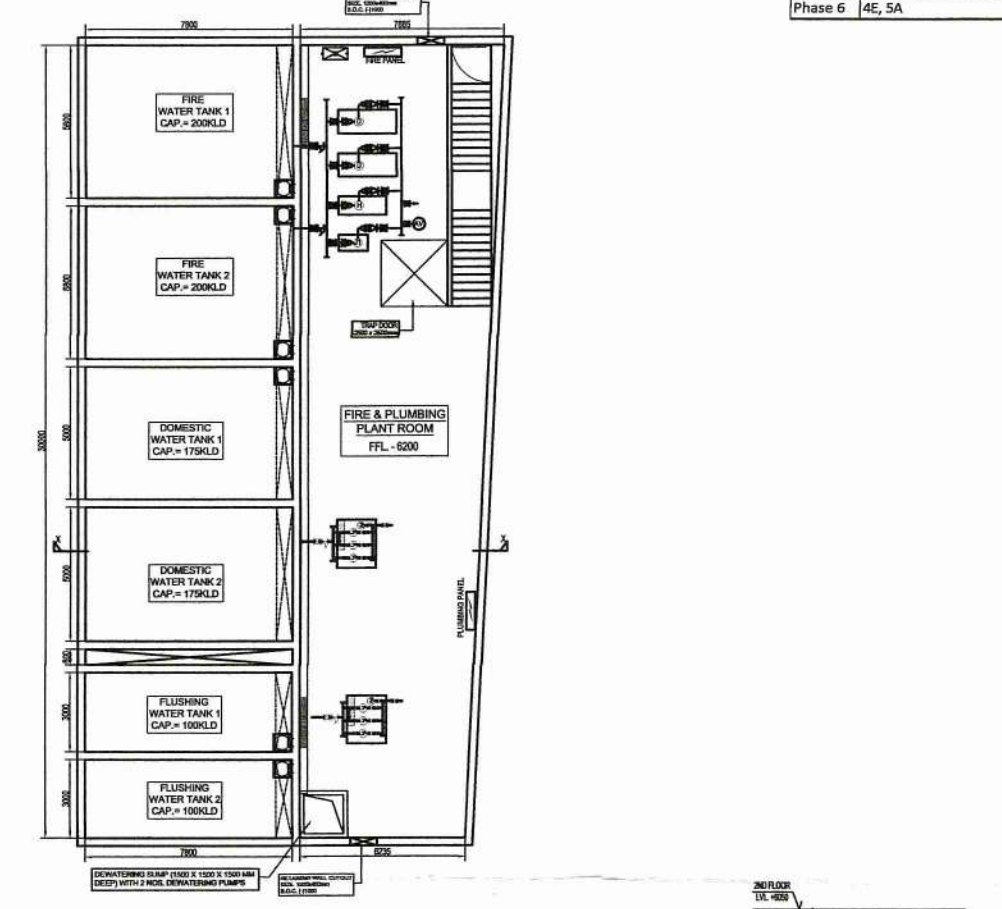

Table: AREA SUMMARY. Columns: SITE AREA, PROPOSED GROUND COVERAGE, PROPOSED FAR, PARKING, EXCLUSIVE TREE PLANTATION AREA.

Plot Details: ARCHITECTURAL DRAWINGS OF PROPOSED 5+13 STORED APARTMENT BUILDINGS FOR AFFORDABLE HOUSING PROJECT OF M/S IABA HOUSING PVT. LTD.

SERVICES CONSULTANT: Consumate Engineering Services (P) Ltd. GIAN P. MATILUR AND ASSOCIATES (P) LTD.

- SPECIFICATIONS:- 1. GRADE OF CONCRETE FOR SUB STRUCTURE IN PILE & PILE CAP WILL BE M30... 2. P.C.C. WORK IN M-10 GRADE CONCRETE.

- NOTES:- 1. ALL DIMENSIONS ARE IN MM. CHAINAGE AND LEVELS ARE IN M. UNLESS OTHERWISE NOTED.

LEGEND: BRICK WORK IN BURNT CLAY BRICKS, BRICK WORK IN FLYASH BRICKS.

IABA HOUSING PVT. LTD. CLIENT: 5 GORKY TERRACE, 2nd FLOOR, KOLKATA, WEST BENGAL-700017

SIGNATURE OF REVIEWER: SANJIB GUHA, STRUCTURAL CONSULTANT.

SIGNATURE OF STRUCTURAL ENGINEER: CHANDI PROSAD KHANNA, BE (Civil), ME (Struct), MIE (India).

SIGNATURE OF GEOTECHNICAL ENGINEER: RUPAK KUMAR BANERJEE, B.C.E.M.E., M.I.G.S., M.I.E., G.T./J.I. (K.M.C.), B.M/GEOTECH-1002.

CONSULTANT/ARCHITECT'S SIGNATURE: GIAN P. MATILUR, ARCHITECT. B. Arch., M.C.A., I.A. CA No.-80/5769

SIGNATURE OF LOCAL ARCHITECT'S SIGNATURE: AR. JUI CHATTERJEE, B-ARCH, Registration No: CA/2021/134352.

SIGNATURE OF OWNER: B. Banerjee, (Signature)

TITLE: SITE PLAN. SHEET NO: 1 OF 1. DRAWN: G.P. CHECKED: S.C. DATE: 15.01.2021.

Table: BUILT-UP AREA DETAIL (IN SQMT.). Columns: FLOOR, TOWER-1A, TOWER-2A&2C, TOWER-2B, TOWER-2A&2B, TOWER-4A, 4B & 4C, TOWER-4D&4E, TOWER-5A, COMMERCIAL, COMMUNITY FACILITY, VIEWING GALLERY, TOTAL.

Approval subject to:- 1. Strict compliance of sanctioned building plans without any deviation.

4. Before commencement of any constructions, it shall be confirmed that the sanctioned building plan along with the conditions is in order with respect to the site measurement and necessary approval from the concerned authority, such as pollution, fire, etc.

THE SANCTION IS VALID UP TO 30/11/2021

APPROVED AS ON: 10/02/2021 Consultant (Planning) WBIDCL

CHECKED & VETTED: (Signature) DATE: 30.11.21

(Signature) 10/12/2021

